

# CRUZE

pleated&cellular



## PERFECT FIT

Perfect Fit Top Down Bottom Up - CZP12



PERFECT FIT ITEM LIST

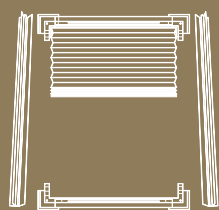

Perfect Fit  
frame and blind



Brackets

or



Konnect Magnetic  
Strip



Alcohol Wipe

TOOLS REQUIRED

Screwdriver

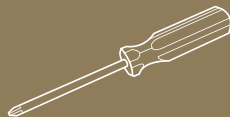

THE INSTALLATION OF THIS PRODUCT SHOULD BE  
CONDUCTED BY SOMEONE COMPETENT IN DIY.

STEP 1  
PUT THE FRAME TOGETHER

1.1

Lay all parts of the frame/blind out face down on a clean even surface.

Your blind will be attached to the top and bottom parts of the frame by side guide cords.

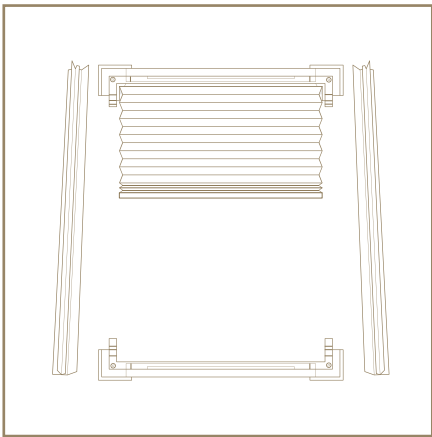

1.2

Slide the left-hand side of the frame on the bottom left-hand corner joint until the latch is secured inside the hole. Repeat the process on the top left-hand corner joint.

Follow the same procedure for the right-hand side of the frame ensuring cords do not become trapped.

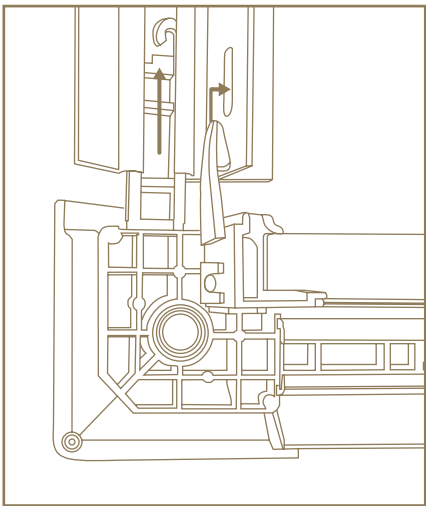

1.3

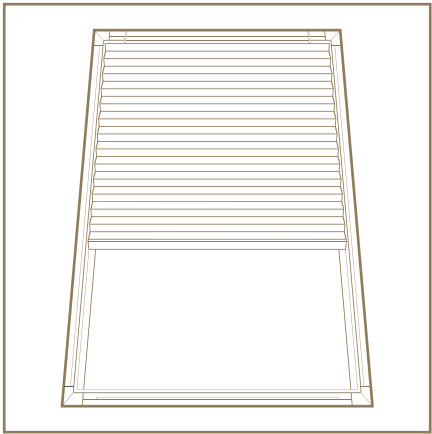

Attach the hook onto the spring. Test operation of blind. If the tension needs to be adjusted, loosen the screw in the locking ring. To increase tension make the cord shorter. To reduce tension make the cord longer and tighten the screw in the locking ring.

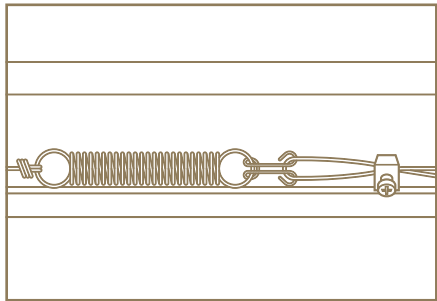

Your Perfect Fit frame and blind are ready to fit.

## STEP 2 - FITTING OPTION (BRACKETS)

### ATTACH THE BRACKETS

#### 2.1

You need to push the brackets between your window pane and the rubber window seal.

The brackets need to be lined up with the bracket hole positions on the Perfect Fit Frame.

Brackets are positioned approximately 85mm from the top and bottom.

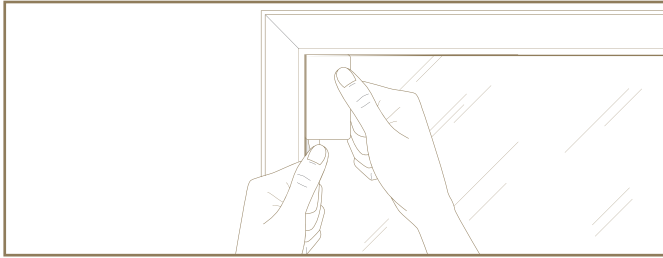

**TIP:** You can use a credit/debit card as a template to find the correct position for the brackets. Place the card length ways along the side of the window in each corner, and line up the bracket with the end of the card as shown.

Press the flat edge of the bracket underneath the window seal. Bracket should be placed with the small tab facing outwards.

Align the brackets with the holes in the frame.

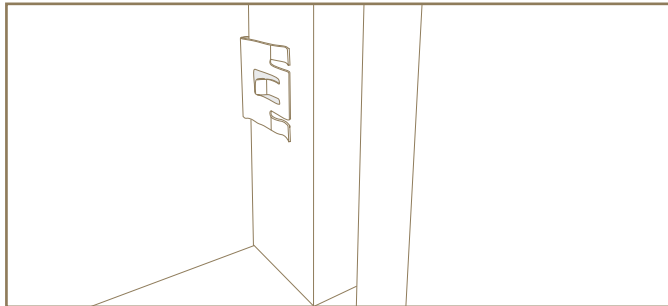

#### 2.2

Fit any intermediate brackets accordingly. Two extra brackets will be supplied for blinds over 110cm drop, these should be positioned approx. mid way down the drop of the blind one on each side. These need to be lined up with the bracket hole positions on the Perfect Fit frame.

**TIP:** If you find that the brackets are difficult to place behind the window seal, you can use a some washing up liquid as lubricant on the flat part of the bracket. Once all the brackets are fitted, clean any excess from the window surface.

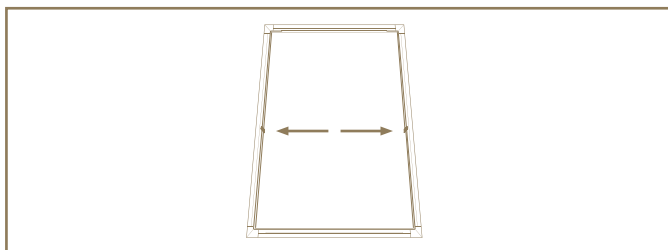

## (KONNECT)

### ATTACH THE MAGNETIC STRIP

#### 2.1

**TIP:** Ensure the area where the magnetic strips are to be applied is clean of dirt and grease. Use the alcohol wipe included to clean surface.

Remove the paper from one side of the magnetic strip exposing the adhesive layer and position along all 4 sides on the back of the blind frame.

Add the other lengths of magnetic strips to the already applied ones. Ensure north/south polarity is correct. If strip keeps moving off centre, the strip should be rotated 180 degrees.

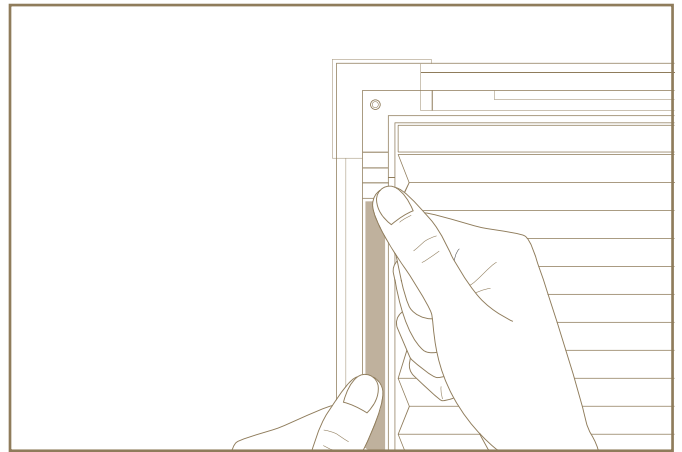

#### 2.2

Remove the remaining paper tape to expose the adhesive layer ready to install the blind.

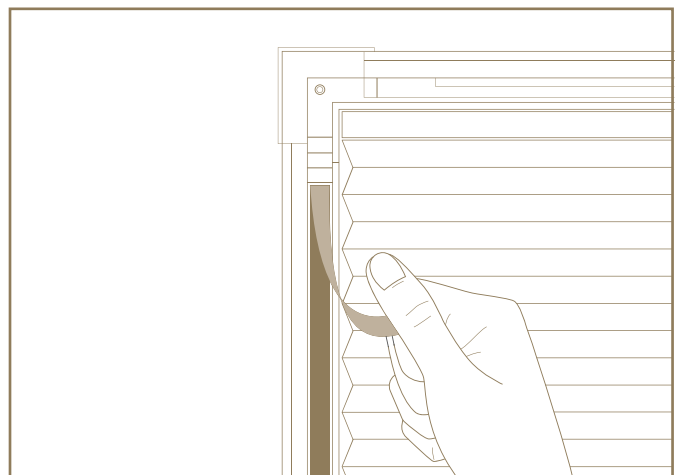

## STEP 3

### (BRACKETS)

#### ATTACH THE FRAME & BLIND TO THE WINDOW

##### 3.1

Line up the holes in the Perfect Fit frame with the brackets.

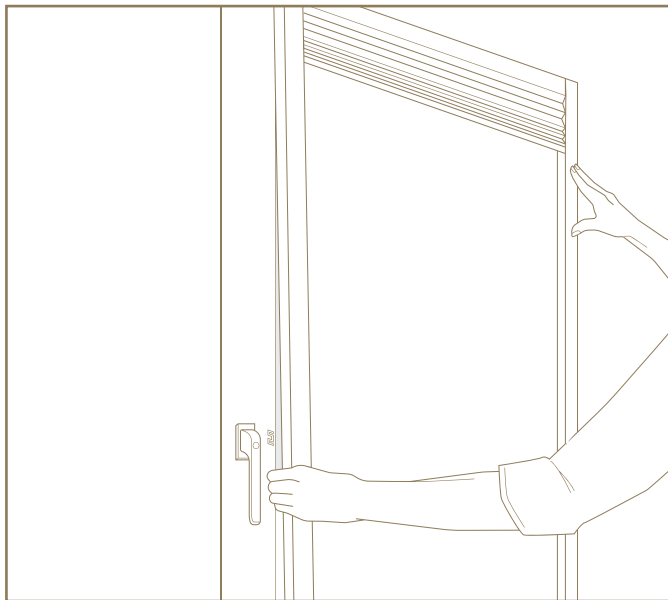

Firmly press the frame onto each bracket one side at a time.

##### 3.2

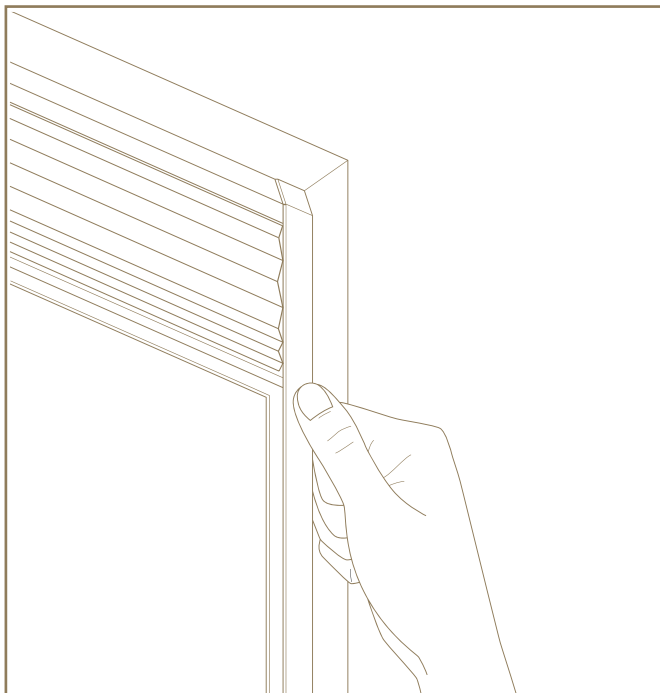

Your frame and blind are now installed.

## (KONNECT)

#### ATTACH THE FRAME & BLIND TO THE WINDOW

##### 3.1

TIP: Ensure the area where the magnetic strips are applied is clean of dirt and grease. Use the alcohol wipe included to clean surface.

Line up the Perfect Fit frame with the window and push the frame into position.

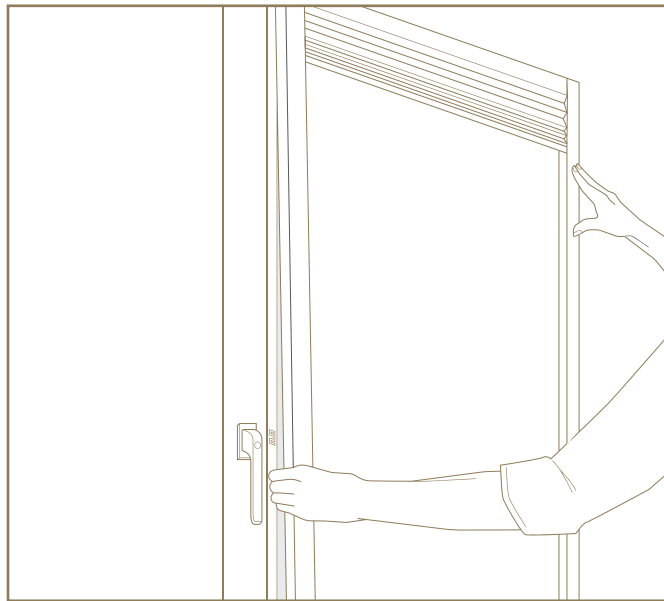

Your frame and blind are now installed.

## STEP 4

#### ATTACH THE HANDLES

When attaching the handles, push flush with the headrail and slide until it has covered the screw block.

NOTE: Cruze logos need to face the same direction as the arrows on the screw blocks.

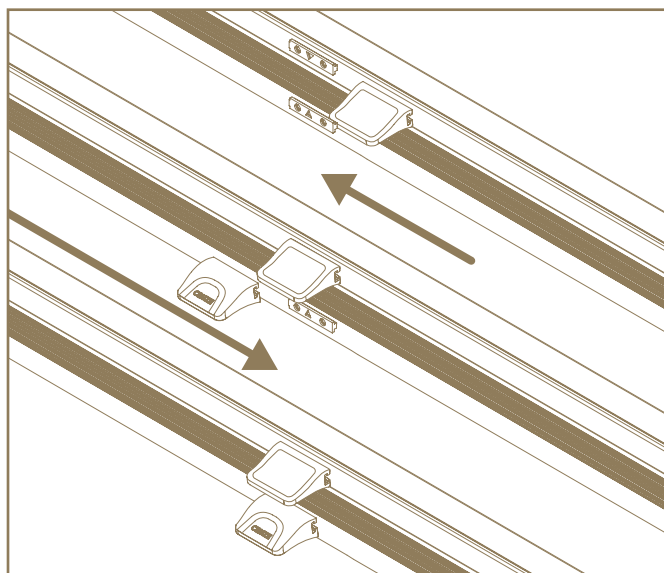

## PLEASE READ THE INSTRUCTIONS BEFORE OPERATING THIS PRODUCT

### OPERATION

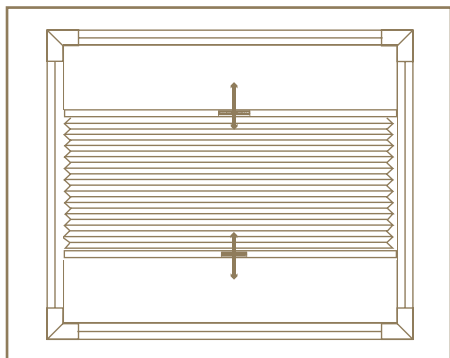

#### TO RAISE & LOWER THE BLIND:

Simply raise and lower the blind to the desired position by firmly holding the handle.

### MAINTENANCE

The product is maintenance free however we recommend that regular visual checks are completed to ensure that no components have been damaged, which could result in operating difficulties and/or cause a safety risk.

If any maintenance is required we recommend that the work is carried out immediately, by a reputable blind company.

We recommend opening and closing your blind regularly to maintain the pleats in the fabric. Recommended that pleated blinds should be stacked overnight, at least once a week to maintain their pleat and shape.

### CLEANING

To prevent blinds from becoming dirty, the blinds should be cleaned regularly with a feather duster.



**make it  
safe**™



### WARNING

Young children can be strangled by loops in pull cords, chains, tapes and inner cords that operate the product.

To avoid strangulation and entanglement, keep cords out of the reach of young children. Cords may become wrapped around a child's neck. Move beds, cots and furniture away from window covering cords.

Do not tie cords together. Make sure cords do not twist and create a loop.

